



SEWAGE SYSTEM INSTALLATION REPORT

F/39/99
FILE NUMBER

REPORT

DATE Oct 27/1999

INSTALLED BY: Milt Peel & Sons

Work authorized by Site Inspection Report for a sewage system has been satisfactorily completed and includes:

- Septic Tank/Holding Tank of working capacity of 1100 gallons (5000L) litres constructed of plastic steel/concrete/brick/glass, Manufacturer WEDCO
 - Distribution Pipe Type Absorption Trench System ☐
 - Filter Bed System ☒ Filter Bed Area 49 sq. m., Contact Area sq. m.
 - Total Lineal Metres in runs of metres and fed by gravity ☒; Siphon ☐; or Pump ☐
 - Size of System based on 5 bedrooms and/or 420 fixture units. Commercial details
 - Structure over 200 M² - YES ☐ NO ☒ 3 STRUCTURES
 - Other (Filter Sand BEAMISH PIT)
- Actual location and orientation of components of sewage system are shown hereunder ☒ or as outlined on the Site Inspection Report For A Sewage System form ☐

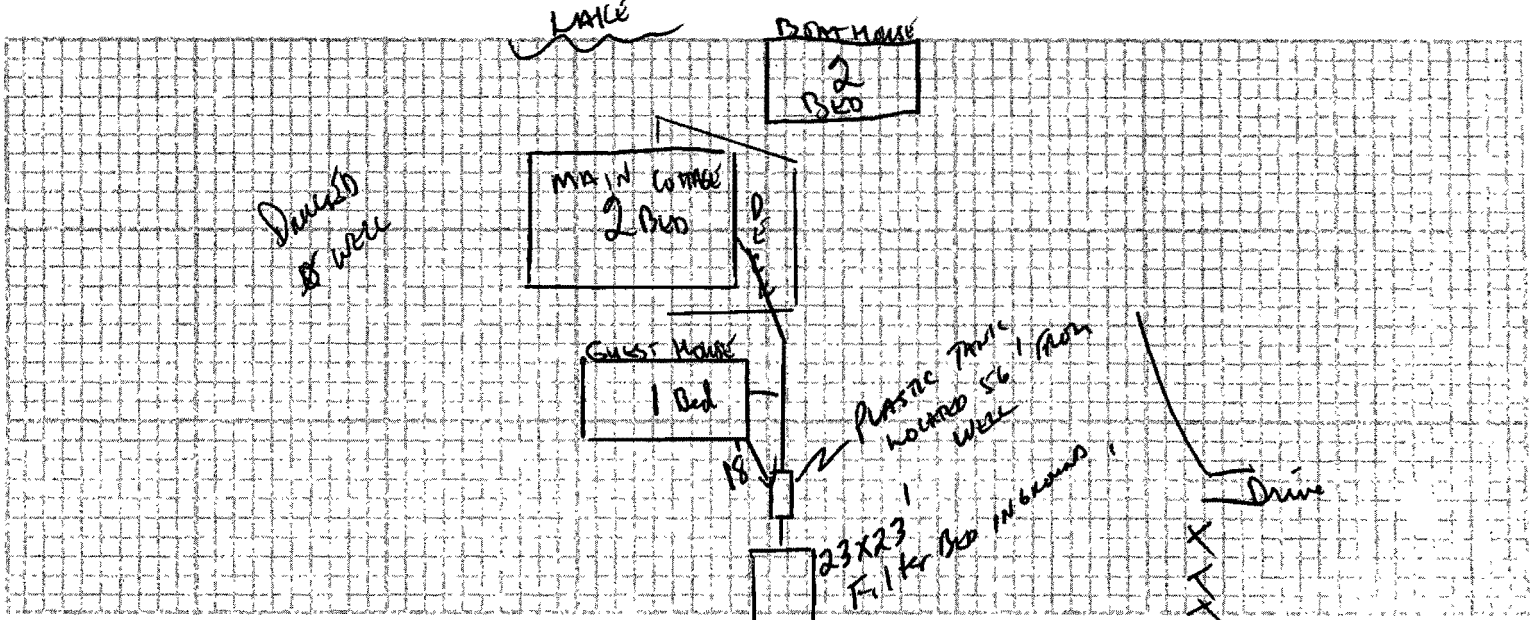

The following work remains to be completed Backfill system and sod or seed ☒ Stabilize all sloped surfaces ☐ Finish grading to shed run-off and divert water around leaching bed ☐ Other Protect Bed + Tank From vehicle traffic

INSTALLATION REPORT

Under the Building Code Act and regulations and subject to the limitations thereof, a permit is hereby issued to

Cheryl Honey

For the use and operation of the Class 4 Sewage System Installed / Altered under Site Inspection Report # F 39 99

Such system being located on Lot 26 Conc 3 Plan 324 Sub. lot Roll No.

Township / Municipality FENELON County VICTORIA

Inspected and Recommended by [Signature]
(Appointed Inspector - Part 8)

Date October 27/1999 Issued [Signature]
(Designated Sewage Inspector - Part 8)

NOTE: No change can be made to any building(s) or structures in connection with which this sewage system is used, if the operation or effectiveness of the sewage system will be affected by the change, unless a Site Inspection Report is obtained.

[Signature]