

Sewage System Installation Report

File Number: LOL-17-06

Installation by: Rick Trotter Date: April 13, 2012

Work authorized by Site Inspection Report for a Sewage System Permit has been satisfactorily completed and includes:

1. Septic Tank/Holding Tank of working capacity of 4500 litres constructed of plastic/concrete/fibreglass
 Manufacturer: NPCP
2. Distribution Pipe: Type: PVC Absorption Trench System Filter Bed System
 Filter Bed Area: 28.4 m² Filter Sand Contact Area 347 m²
 Total 25.6 Lineal Metres in 6 runs of 4.3 metres and fed by: Gravity Siphon or Pump
 Loading Rate Area: 171 + extra sand fill all around m² 15 metre constructed mantle provided: (Yes) No (circle)
3. Size of System based on 3 bedrooms and/or 21 fixture units. Commercial details: _____
 Area of Building: 213 m² Total Daily Design Sewage Flow: 1800 litres
4. Other Bottom of stone at original grade

Diagram of Installation as observed by Inspector:

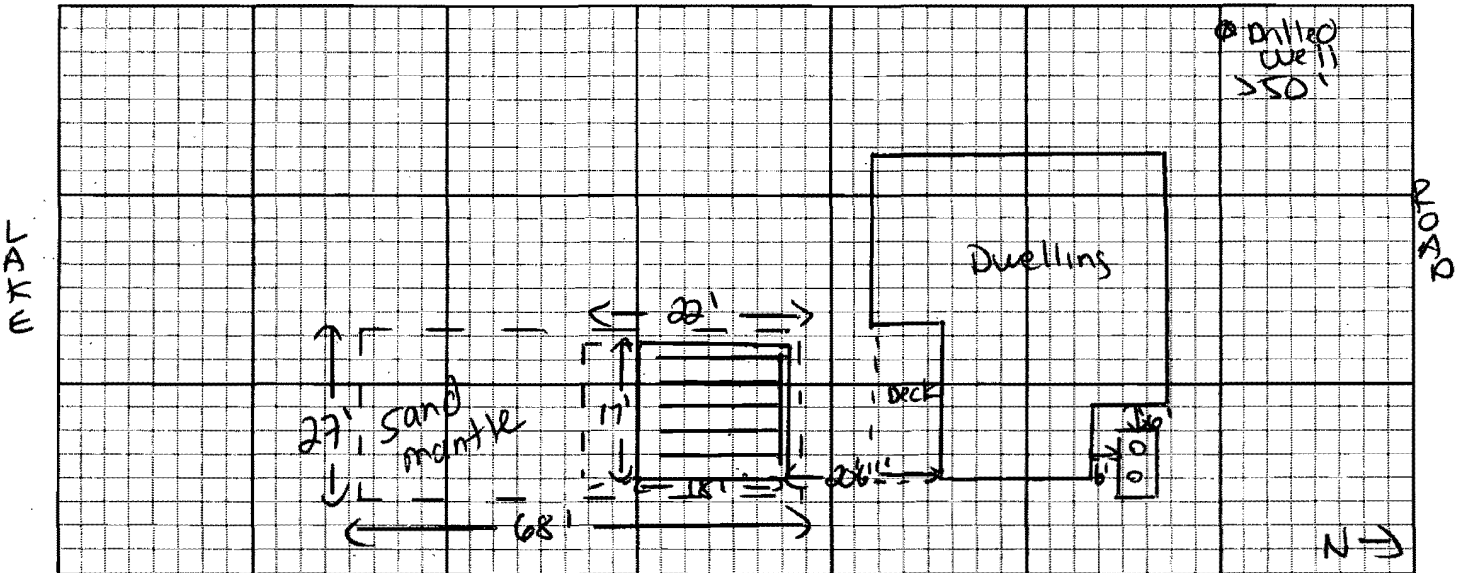

Ensure the following work is completed: 1) Backfill system and sod or seed 2) Stabilize all sloped surfaces 3) Finish grading to shed run-off and divert water around leaching bed 4) If a pump is used after the tank, ensure the weeping tile are dosed to 75% capacity in 15 minutes and include a high level alarm in case of pump failure.

Comments: System not designed to accept backwash water from a water treatment device

INSTALLATION REPORT

Under the Building Code Act and regulations, and subject to the limitations thereof, a permit is hereby issued to:

Brent & Kelly Quartermain

For the use and operation of the Class 4 Sewage System Installed/Altered under Site Inspection Report # LOL-17-06

Such system being located on Lot #: 3 Conc. #: 11 Plan #: STR 2590 Sub Lot#: Pt-6.

Civic (Emergency, Fire, 911) # 30 Street: Courtland Rd.

Roll # 1651 4200 0118 501 0000 Township/County/City: LOL / CKL

Inspected & Recommended by (Appointed Inspector - Part 8): Mile 33 Date: Apr 16/12

Reviewed (Part 8 Coordinator): Pete Haugwarer Date: April 16, 2012

[Handwritten signature]